

Manual
NDW6000
Wireless HDMI Display P2P Dongle

1. INTRODUCTION

1.1 Product Feature

- **NDW6010Z1:**
 - Tethered USB-C Cable length 5cm · USB-C DP Alternate mode
 - Wi-Fi display share screen 1920x1080 @60Hz
- **USB-A to HDMI cable:**
 - Tethered USB-A 2.0 To HDMI Cable length 60cm
 - HDMI1.2, 1920x1080p@60Hz, Wireless display 1080p@60Hz

1.2 Product Appearance

NDW6010Z1



USB-A to HDMI cable



- | | |
|--------------------------|---------------------------------|
| 1 USB-C with DP Alt Mode | 2 Pair and Screen On/Off Button |
| 3 Reset Key | 4 Indicator LED (White) |
| 5 Reset Button | 6 HDMI to Monitor |
| 7 USB-A 5V Power Supply | |

1.3 Application Diagram

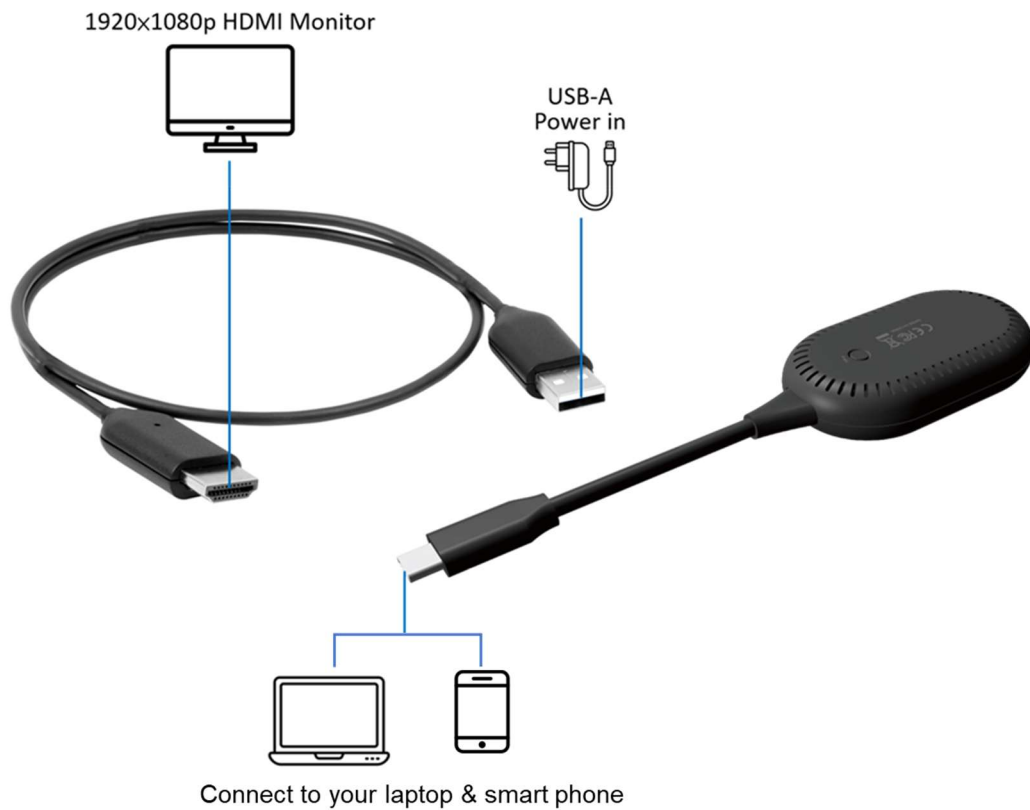

2. System/laptop or mobile phone Requirement

- The PC /Laptop / or Mobile phone USB-C port should support DP Alternate mode output
- Supported Laptop/or Mobile phone Operating System:
 - Windows® OS
 - MacOS
 - iOS
 - Android OS
 - Linux
 - ChromeOS

NDW6000Z1 1080 HD operation

Get started:

1. Initiate the USB-A to HDMI cable receiver
 - a. Connect the cable's USB-A port to a USB-A output on the device.

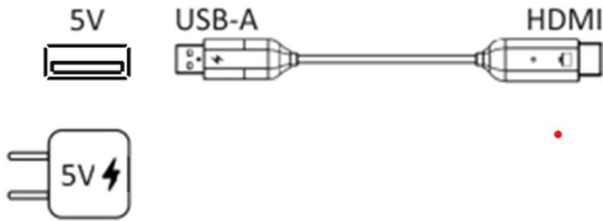

2. After booting, enter the main interface as below

- a. Connect the HDMI port to a HDMI input on a device.



Pairing

- b. Connect the USB-C port to the laptop / or mobile phone USB-C port.

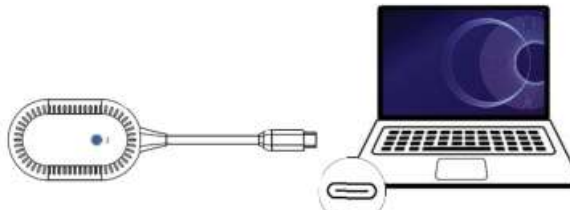

The laptop/or mobile phone 's screen can mirror to the monitor/or TV automatically.



3. MECHANICAL SPECIFICATION

3.1 Mechanical Drawing

NDW6010Z1

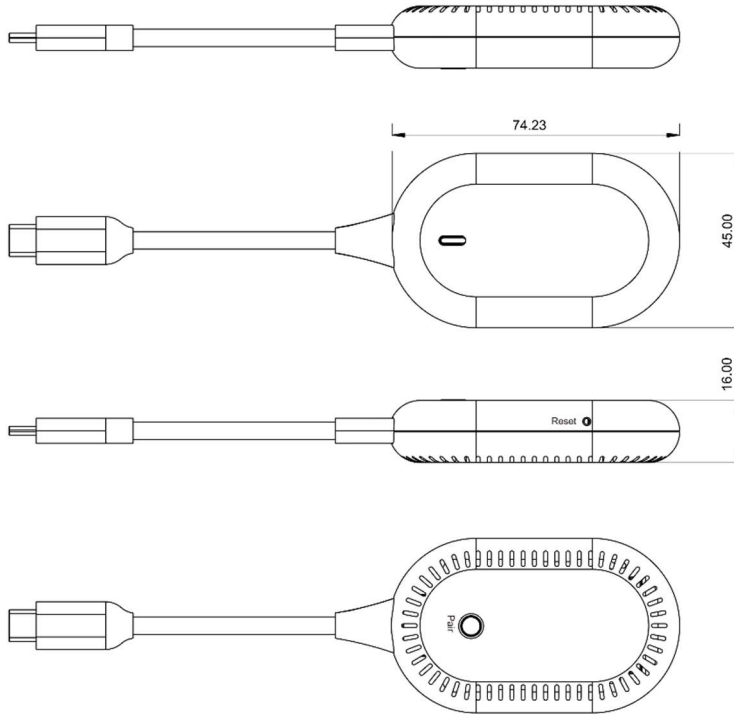

NDW6020Z1

USB-A to HDMI cable

